

## PARROT PEAK ROOF PLAYGROUND CAGE EXTRA LARGE



**Size:** W: 111cm x L: 84cm x H: 165cm

### **Key Features:**

- **Premium Powder-Coated Metal Construction:** Built to last, the Breeders Secret Bird Cage is constructed from high-quality powder-coated metal. This heavy-duty material ensures durability, longevity, and resistance to rust, making it the perfect choice for housing your avian companions securely.
- **Heavy Duty Wire:** Rest easy knowing that your birds are safe and secure within the heavy-duty wire walls of this cage. The sturdy wire design provides both security and visibility, allowing you to keep an eye on your pets while they enjoy their cozy haven.
- **Slide-Out Trays for Easy Cleaning:** Cleaning has never been easier! With the convenient slide-out trays, you can effortlessly maintain a clean and hygienic environment for your birds. Simply remove the trays, dispose of waste, and slide them back in.
- **Castors for Effortless Mobility:** The inclusion of castors on the bottom of the Breeders Secret Bird Cage allows you to move it around your home with ease. Whether you want to relocate it for a change of scenery or simply need to access a different area of your living space, this cage effortlessly glides into place.
- **Includes Feeder and Drinker:** We've taken the guesswork out of setting up your bird's habitat. The Breeders Secret Bird Cage comes complete with a feeder and drinker, ensuring your feathered friends have access to food and water right from the start. It's all about convenience for you and comfort for your birds.

## Assembling Instruction Sheet for Parrot Peak Roof Playground Cage Extra Large

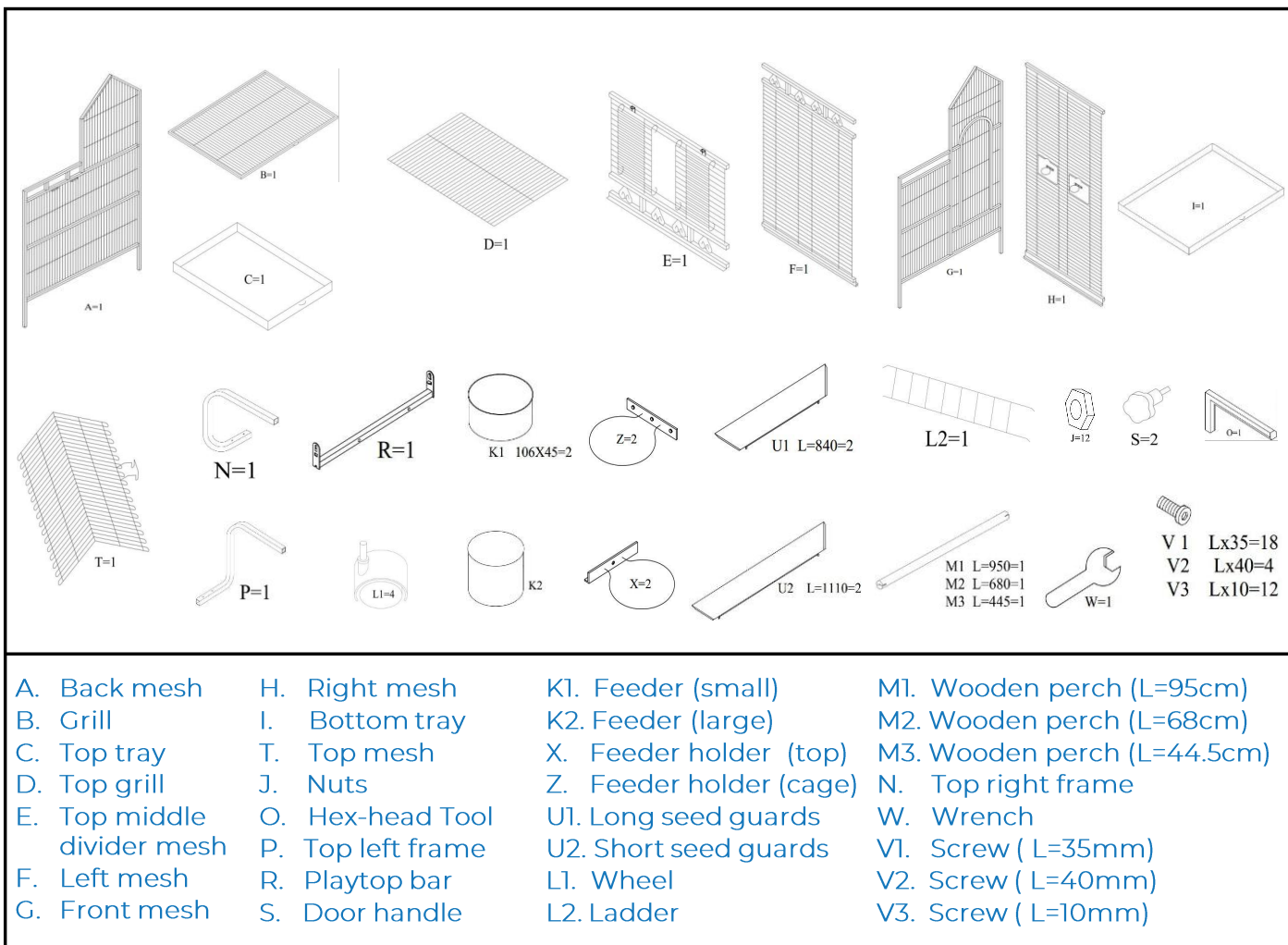

It is recommended that two people assemble this cage

## Step 1:

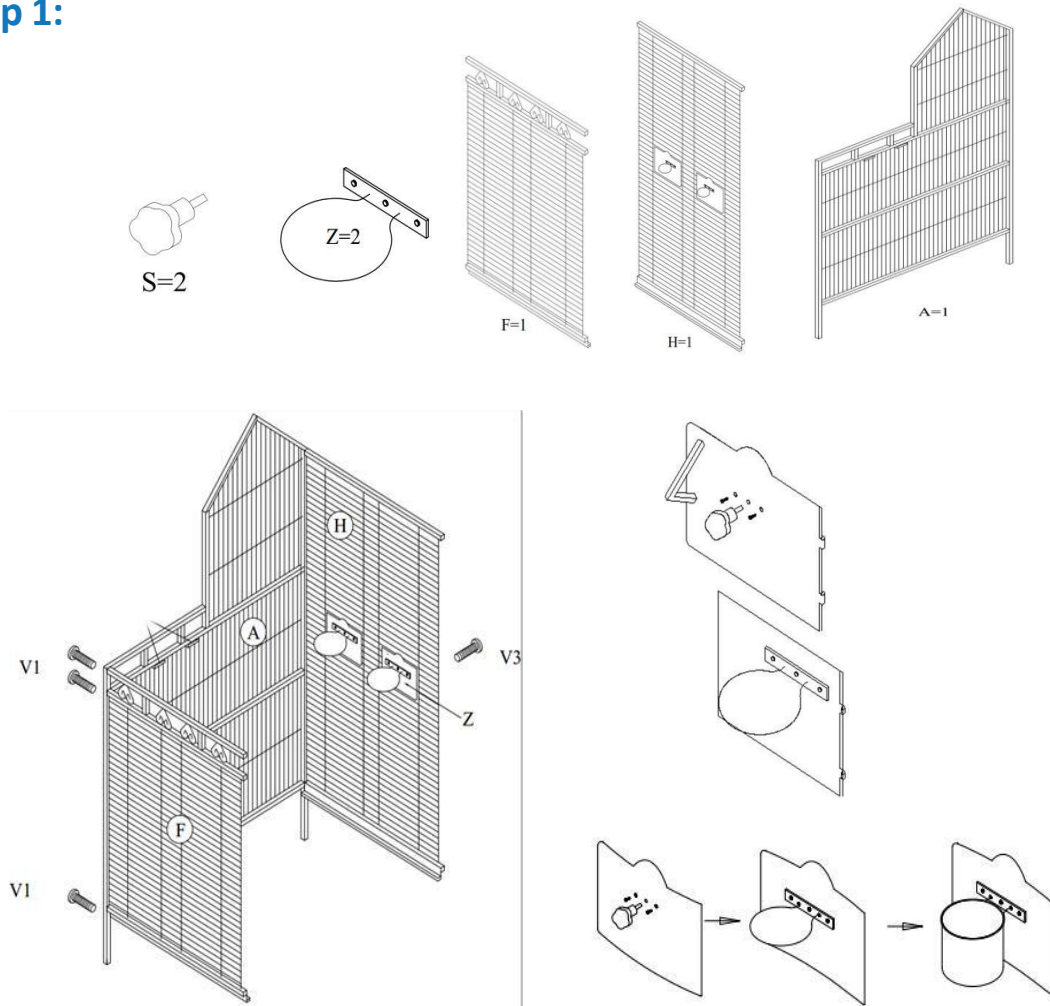

Use 6 x V1 to connect mesh A & H & F.

Assemble 2 x Z on the feeder door, then fix it with 4 x V3 and S (as shown), and place K2 on Z

## Step 2:

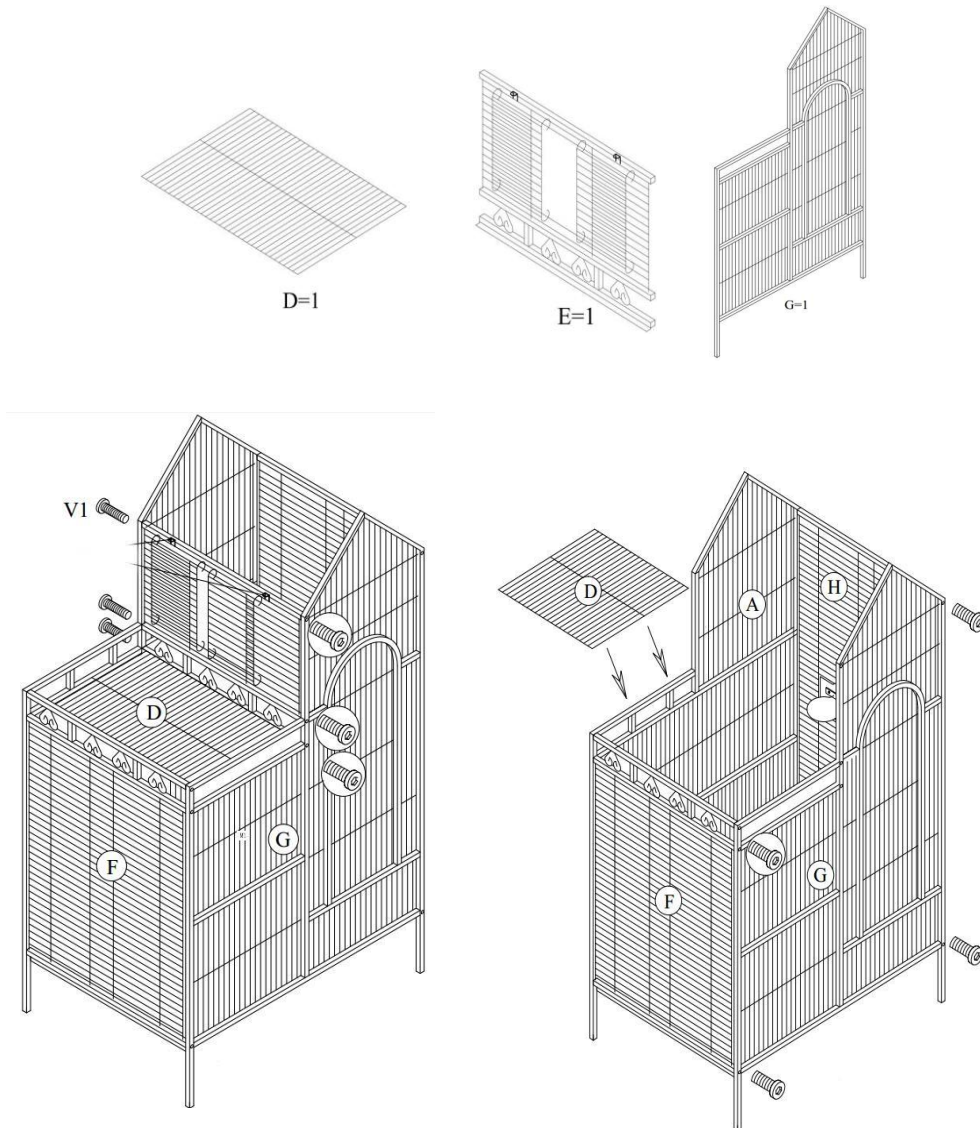

Connect the mesh F, H and G with 4 x VI; Place D as shown;  
Connect E between A and G with 6 x VI

### Step 3:

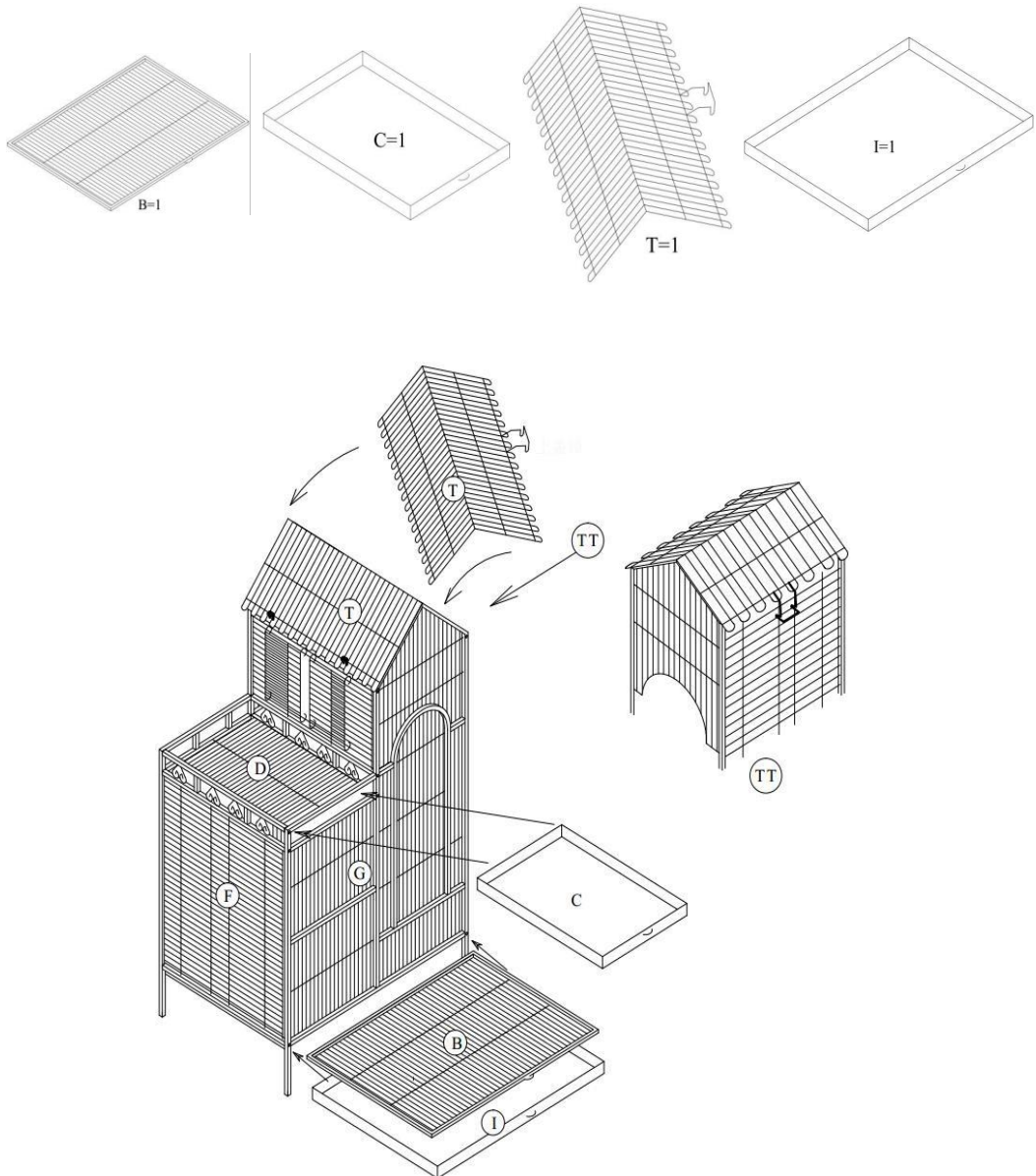

Place T, C, B, and I in the corresponding positions as per diagram.



## Step 4:

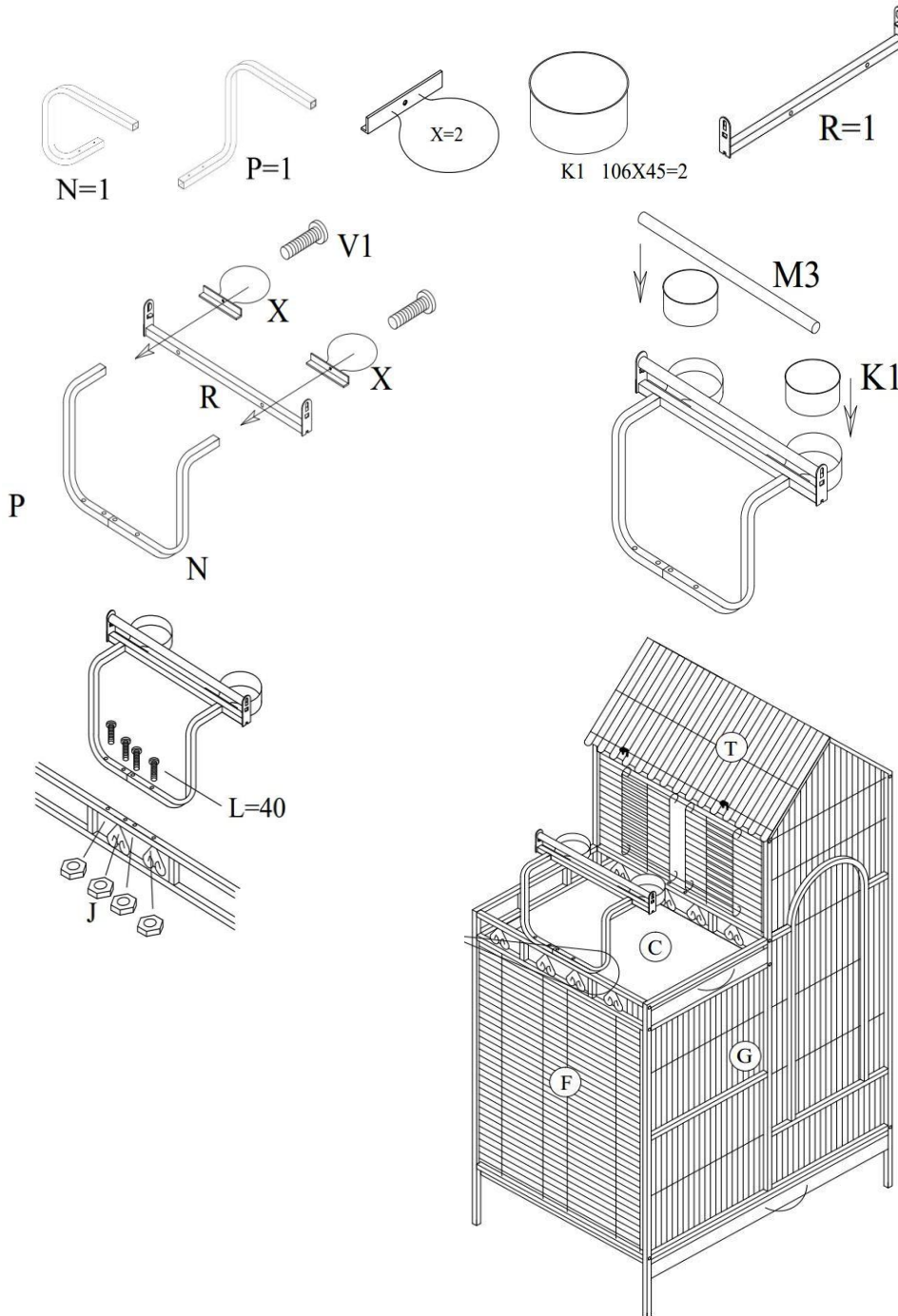

Connect 2 x X and assemble R & P & N with 2 x V1 as the above photo shows. Place K1 and M3 as shown; Connect P & N to the top of F with 4 x V2 & J

## Step 5:

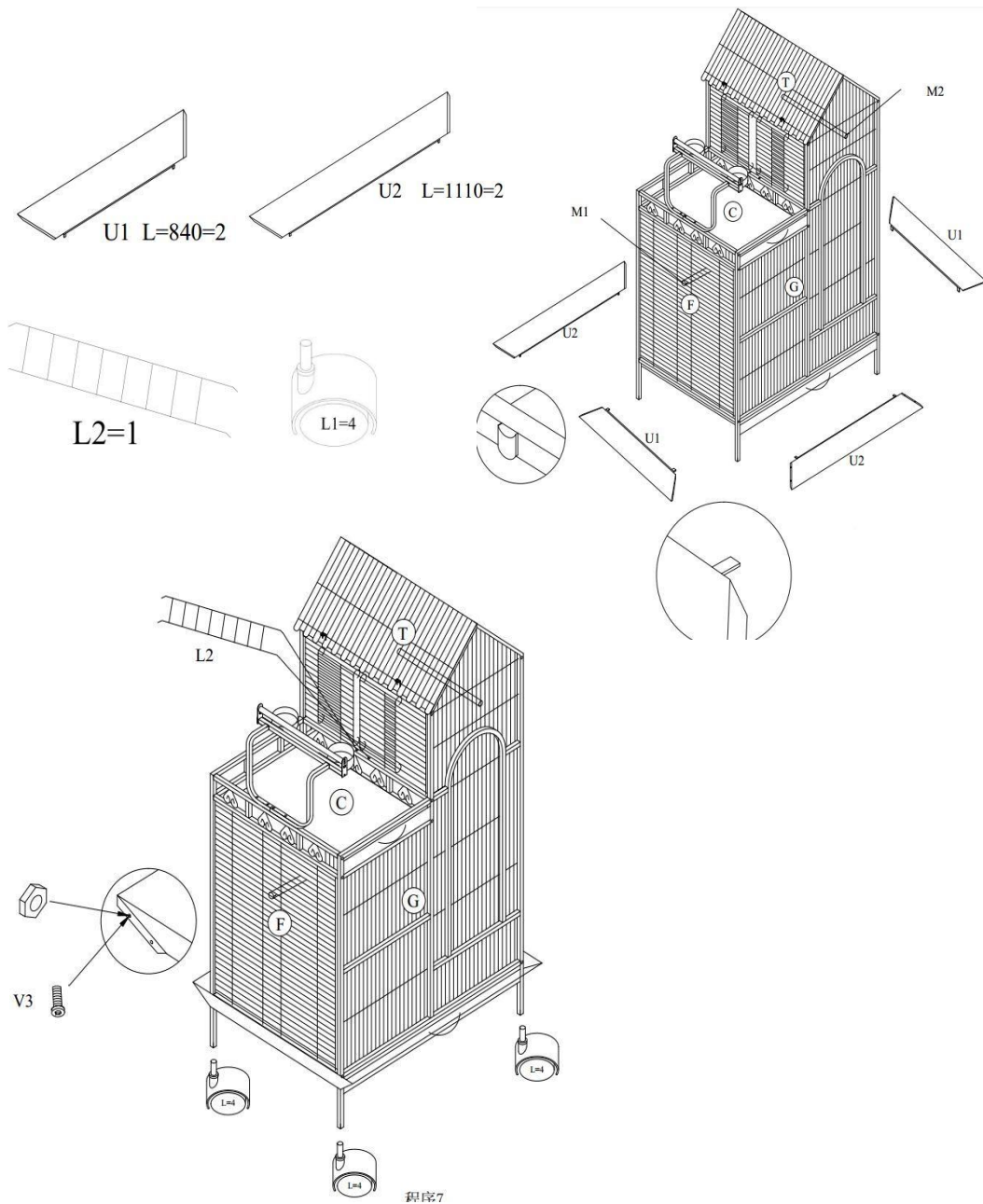

Put M1 & M2 into the cage, and assemble 2 x U1 and 2 x U2 with 8 x V3 & J as left show.

Put L2 into the hole where E and R are connected;  
Insert the wheel into the bottom bracket.

## Finished Product:

