

PARROT PLAYGROUND CAGE – MEDIUM



Size: W: 62.8cm x L: 62.8cm x H: 190cm

Key Features:

- **Premium Powder-Coated Metal Construction:** Built to last, the Breeders Secret Bird Cage is constructed from high-quality powder-coated metal. This heavy-duty material ensures durability, longevity, and resistance to rust, making it the perfect choice for housing your avian companions securely.
- **Heavy Duty Wire:** Rest easy knowing that your birds are safe and secure within the heavy-duty wire walls of this cage. The sturdy wire design provides both security and visibility, allowing you to keep an eye on your pets while they enjoy their cozy haven.
- **Slide-Out Trays for Easy Cleaning:** Cleaning has never been easier! With the convenient slide-out trays, you can effortlessly maintain a clean and hygienic environment for your birds. Simply remove the trays, dispose of waste, and slide them back in.
- **Castors for Effortless Mobility:** The inclusion of castors on the bottom of the Breeders Secret Bird Cage allows you to move it around your home with ease. Whether you want to relocate it for a change of scenery or simply need to access a different area of your living space, this cage effortlessly glides into place.
- **Includes Feeder and Drinker:** We've taken the guesswork out of setting up your bird's habitat. The Breeders Secret Bird Cage comes complete with a feeder and drinker, ensuring your feathered friends have access to food and water right from the start. It's all about convenience for you and comfort for your birds.

Assembling Instruction Sheet for Parrot Playground Cage – Medium

- | | | |
|--------------------------------|----------------------|--------------------|
| A: Front panel | H: Playtop bar | M4: Screws (M6*35) |
| B: Back panel | I: Left perch ring | M5: Screws (M8*18) |
| C1: Left-side panel | J: Right perch ring | N: Nut |
| C2: Right-side panel | K: Cup | N1: Wing Nut |
| D1: Handle of door | L: Perch for playtop | O: Toy hook |
| D2: Cup holder for Cage | L1: Perch for body | P: Seed guard |
| D3: Cup holder for Playtop Bar | M1: Screws (M6*10) | Q: Metal tray |
| E: Top grill | M2: Screws (M6*20) | W: Bottom grill |
| F: Wheels | M3: Screws (M6*25) | X: Bottom Panel |
| G: Ladders | | |

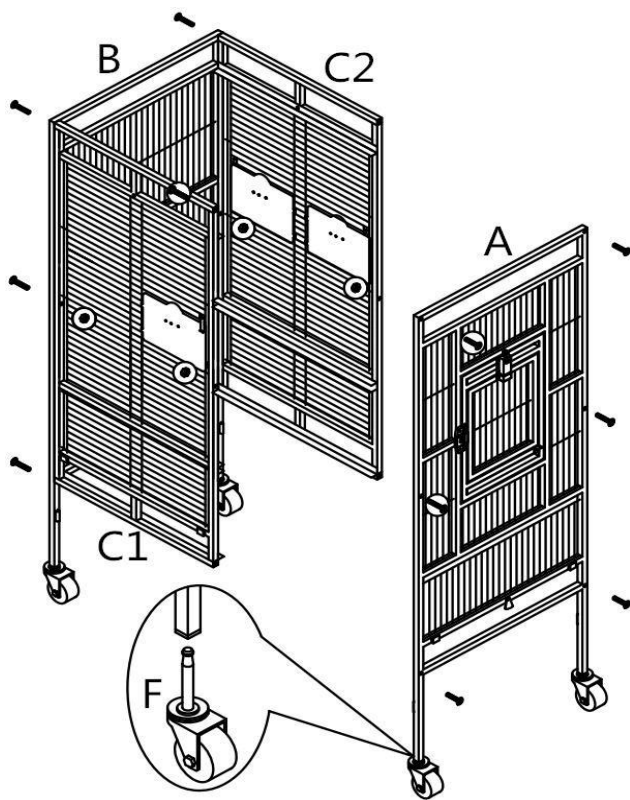

Step 1: Put F into the legs on A and B. Use M3 to connect A, B, C1 and C2. See the picture on left.

Step 2: Put E on the top, and use M3 to fix it. Put X on the bottom of cage, see the picture on right.

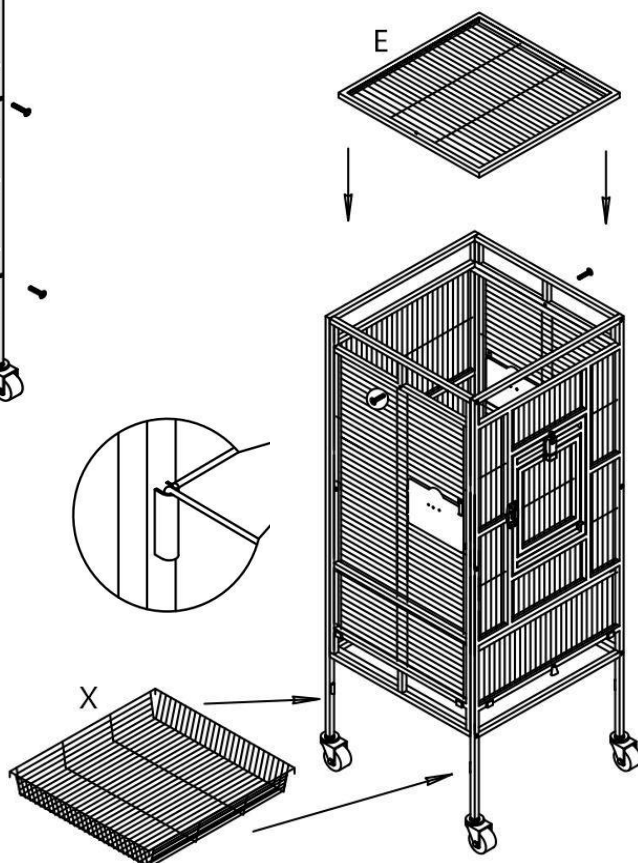

Assembling Instruction Sheet for Parrot Playground Cage – Medium

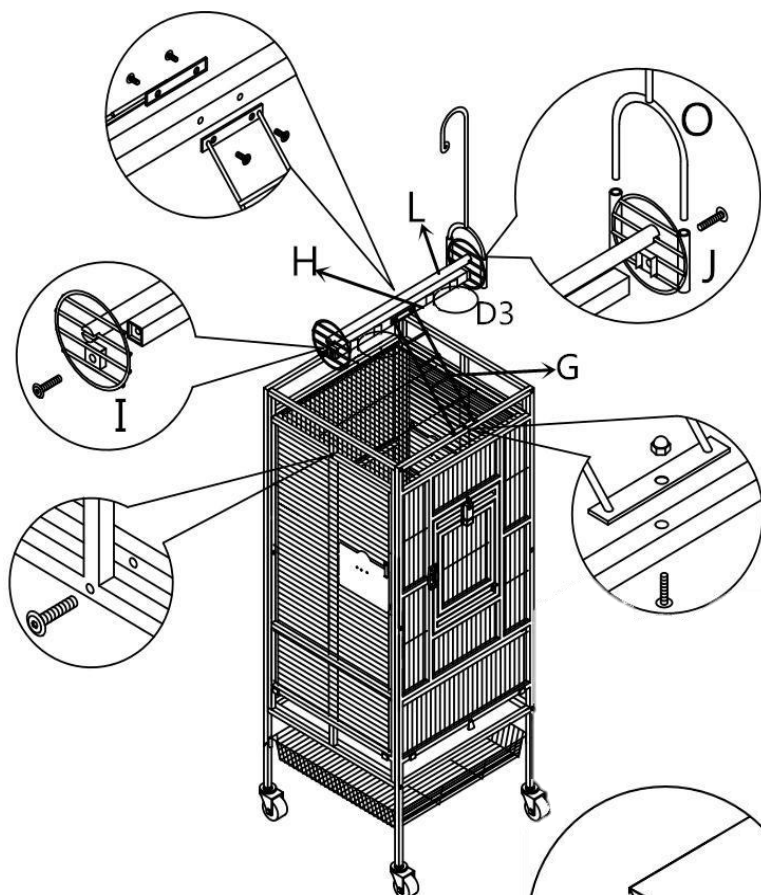

Step 3: Use M2 and N1 to fix one end of G on top of A and B, use M1 to connect another end of G with H. Use M5 to fix I and J on two sides of H. Use M4 and N to fix D3 on H. Then to assemble O, L and K as the picture on left.

Step 4: Assemble P around the cage, use M1 and N to fix them. Use M1 to fix D2 on the door between C1 and C2, then put K on D2 use D1 to fix. Assemble Q and W as the picture on right, put L1 inside the cage body. The cage is finished!

